

Are you ready **for LTE?**

Discover the new device Televes has developed to block incoming LTE/4G whilst allowing you to enjoy watching your favourite TV channels.

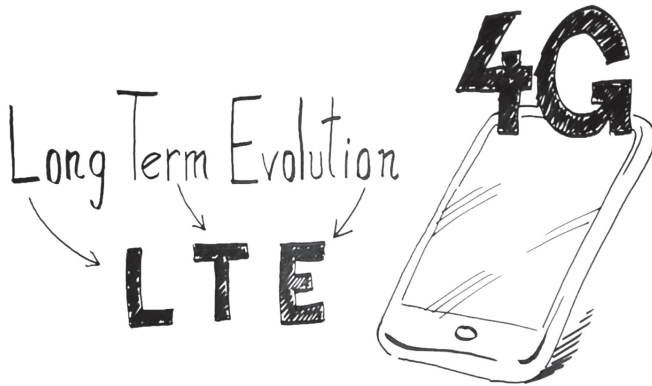

What is LTE?

Long Term Evolution (LTE), also known as 4G, is the technology that allows the increase in capacity of the current mobile phone network, allowing consumers in the UK and Europe to get the most out of their new mobile handsets, enjoying all sorts of connected services with virtually no limit in terms of connection bandwidth.

What and who could be affected?



Due to its power and proximity in the radioelectric spectrum, LTE/4G could generate interference over DTT (Freeview). If this was to happen TV reception would be affected, and could affect the quality of sound and/or picture on your TV.

In order to avoid this interference and ensure perfect reception of Freeview, households should fit specific LTE/4G filters. These filters have been specifically designed and tested for this purpose and will carry the AT800 logo.

When will it affect us?

Current Freeview services will have to clear frequencies above 790MHz (UHF channels 61 and 62) in order for the new 4G licensees to deploy. This process will take place **between March and October 2013**, depending on the area.

Do it yourself and continue watching TV

Step up to 4G signals and prepare your home TV installation **using Televes Filters**

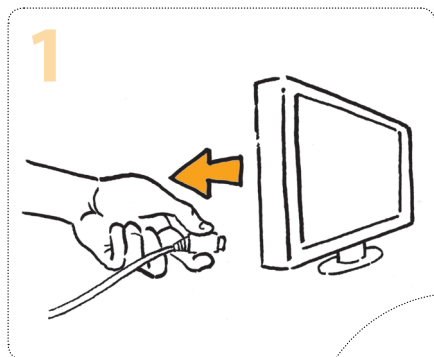

Unplug the aerial cable from the back of your TV.

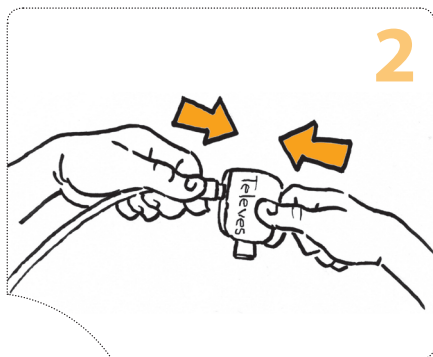

Connect the end of the cable that has been unplugged from the TV to the female connector of the filter.

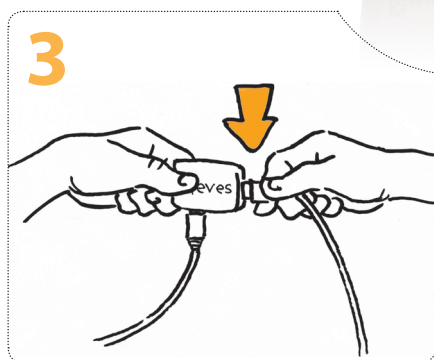

Connect the female connector on the cable lead to the male connector on the filter.

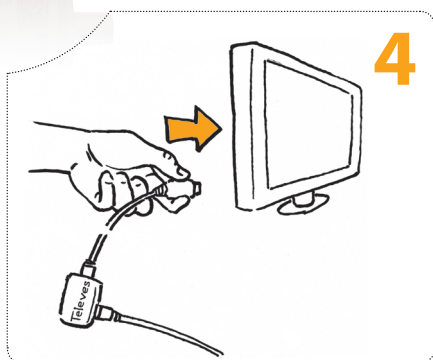

Connect the loose end of the cable lead to the connector on the TV.

Now you are ready

For more information visit:

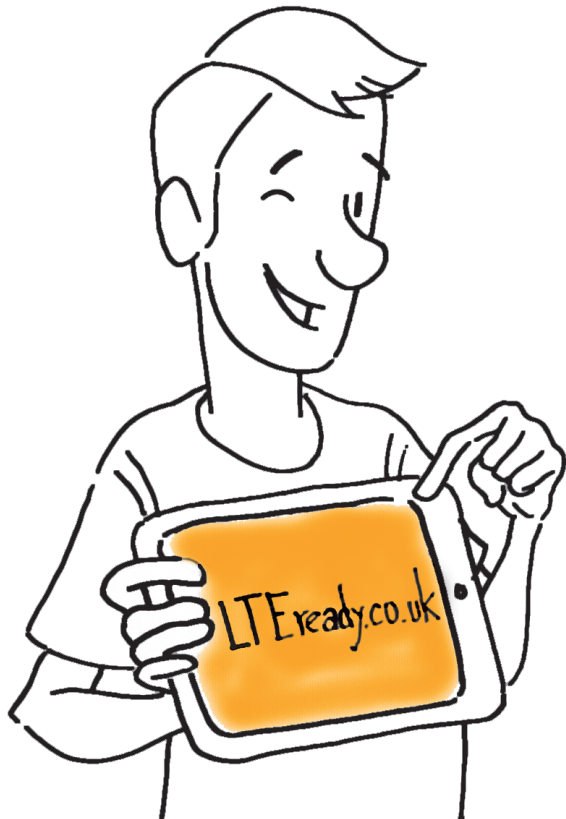

scan code
to watch video



100% Designed, Developed & Manufactured by Televés Corporation
televescorporation ■ televés.com ■ televés@televés.com

Televés[®]